

## TECHNICAL DATA SHEET

**31-131-\*-A/C**

**Wall mounted shower seat**  
height adjustable

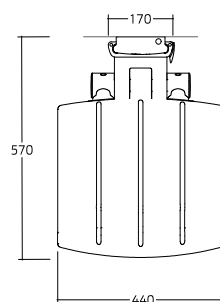

TOP

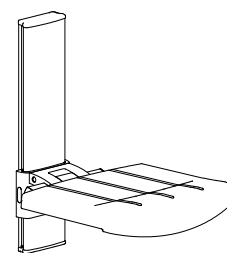

PERSPECTIVE

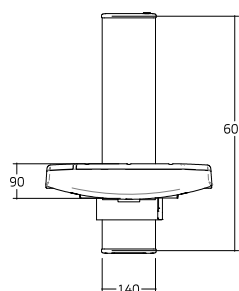

FRONT

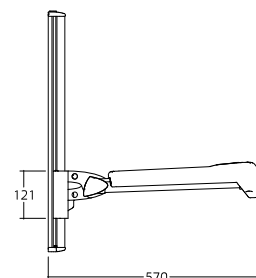

SIDE

### PRODUCT DATA:

- Item code:** 31-131-\*-A, 31-131-\*-C
- Item Description:** Wall mounted shower seat, height adjustable.
- Length:** NA
- Dimensions:** NA
- Includes:** NA
- Type:** NA
- Flexibility:** Fixed, Height adjustable
- Adjustability:** Manually adjustable.
- Materials:** Aluminium, Stainless steel, ABS, Nylon, XL EXTRALIGHT®
- Finish:** Anodized, Similar stainless steel.
- Colour:** \*White; red; blue; black; dark grey.
- Max loading weight:** NA
- Max user weight:** 150 kg - 330 lbs/1 m
- Country of Origin:** Italy.

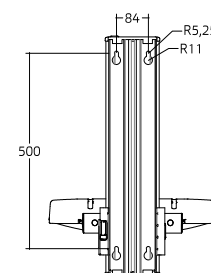

BACK

<b>BLACK</b> Colour code 30	<b>WHITE</b> Colour code 00	<b>RED</b> Colour code 10	<b>BLUE</b> Colour code 20	<b>DARK GREY</b> Colour code 35	<b>ANODIZED</b> STAINLESS STEEL Colour code -A	<b>SIMILAR</b> STAINLESS STEEL Colour code -C
-----------------------------------	-----------------------------------	---------------------------------	----------------------------------	---------------------------------------	---	--



\*The above data cannot be binding, Profilo Smart Ltd. reserves itself the right to make technical or aesthetic modifications without notice at any time.  
PROFILO SMART LTD. Guinness Enterprise Centre, Taylor's Lane, Dublin, D08, Ireland. Phone: +353 (0)1 687 4074 Email: info@profilosmart.com