

TECHNICAL DATA SHEET

22-201-*-A/C
Wall mounted backrest
for toilet

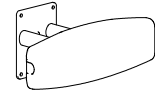
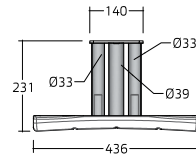

TOP

PERSPECTIVE

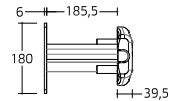
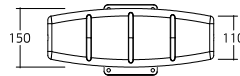

FRONT

SIDE

PRODUCT DATA:

- Item code:** 22-201-*-A, 22-201-*-C
- Item Description:** Wall mounted backrest for toilet.
- Length:** NA
- Dimensions:** NA
- Includes:** NA
- Type:** NA
- Flexibility:** Fixed.
- Adjustability:** NA
- Materials:** Aluminium, Stainless steel, ABS, Nylon, XL EXTRALIGHT®
- Finish:** Anodized, Similar stainless steel.
- Colour:** *White; red; blue; black; dark grey.
- Max loading weight:** 150 kg - 330 lbs/1m
- Max user weight:** NA
- Country of Origin:** Italy.

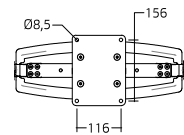

BACK

BLACK Colour code 30	WHITE Colour code 00	RED Colour code 10	BLUE Colour code 20	DARK GREY Colour code 35	ANODIZED STAINLESS STEEL Colour code -A	SIMILAR STAINLESS STEEL Colour code -C
-----------------------------------	-----------------------------------	---------------------------------	----------------------------------	---------------------------------------	---	--



*The above data cannot be binding, Profilo Smart Ltd. reserves itself the right to make technical or aesthetic modifications without notice at any time.
PROFILO SMART LTD. Guinness Enterprise Centre, Taylor's Lane, Dublin, D08, Ireland. Phone: +353 (0)1 687 4074 Email: info@profilosmart.com